

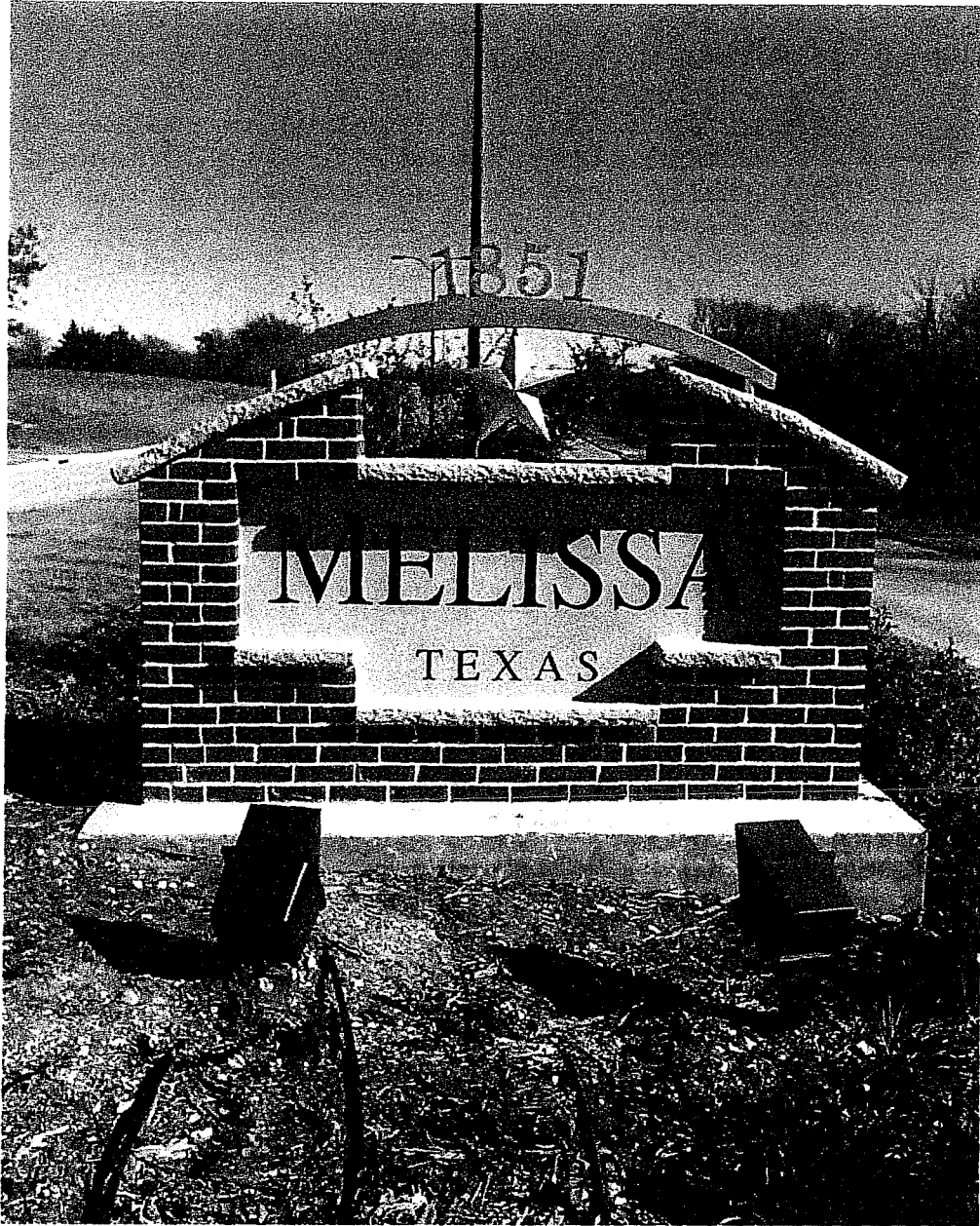

*Easy to Find.  
Hard to Leave.*

GPS Control Network

City of Melissa  
**GPS Control Network**



established by

***Maddox Surveying & Mapping, Inc.***

P.O. Box 2109

Forney, Texas 75216

(972) 564-4416

City of Melissa  
**GPS Control Network**



# GPS SURVEY NEW MONUMENT DATA SHEET

CITY OF MELISSA  
901 State Highway 121  
Melissa, TX 75454-9501  
(972) 838-2338

UNIT SERIAL NO.

DC-1

CREW MEMBERS:

BM/JT

STATION NAME (PID):

364-1

PROJECT NAME:

MELISSA

DATE:

12/08/08

GRID COORDINATES

NORTH

7164690.332

EAST

2552099.938

DEGREES / MINUTES / SECONDS

LATITUDE

33 18 34.52771

LONGITUDE

96 35 22.35168

GRID FACTOR:

0.99985739

ELEVATION (FT)

613.119

TIME

START

9:15 AM

END

12:15 PM

ANTENNA HEIGHT  
(MEASURED FROM HOOK)

FEET

5.530

METERS

1.686

STATION DESCRIPTION:

2 inch aluminum disk stamped "R.P.L.S. 5430" "GPS Mon" "364-1" "M.S.M. Inc." set in concrete at the northeast corner of Highway 75 and Throckmorton Rd (FM 364). Monument is approx. 25' west of the centerline of the Highway 75 on-ramp and approx. 3' northeast from the north end of a headwall. Headwall contains a 24" R.C.P. Monument is approx. 101' northeast from an Ice Warning sign.

REMARKS:

Log file: log1208a.tps

STATION SKETCH:

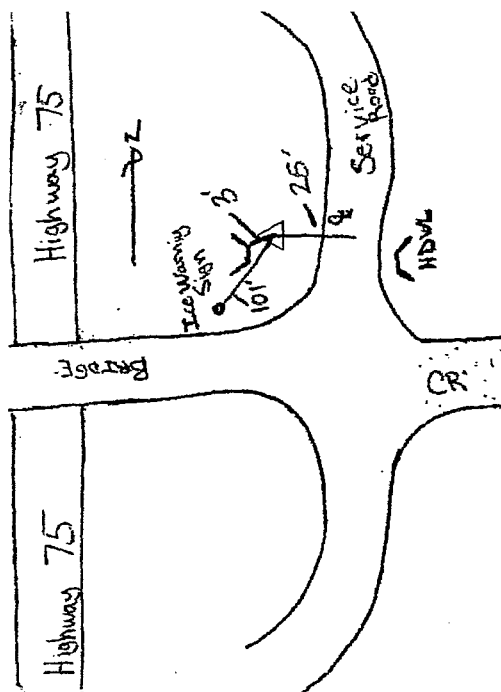
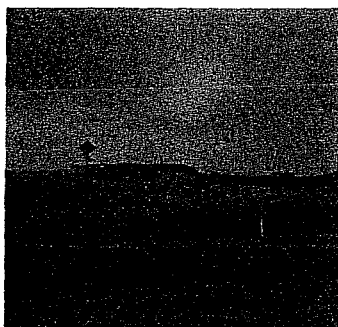

# GPS SURVEY NEW MONUMENT DATA SHEET

CITY OF MELISSA  
901 State Highway 121  
Melissa, TX 75454-9501  
(972) 838-2338



UNIT SERIAL NO. DC-2		CREW MEMBERS: BM/JT		CITY OF MELISSA 901 State Highway 121 Melissa, TX 75454-9501 (972) 838-2338	
STATION NAME (PID): BF-1		PROJECT NAME: MELISSA		DATE: 12/05/08	
GRID COORDINATES		DEGREES / MINUTES / SECONDS			
NORTH 7152466.377	EAST 2558682.389	LATITUDE 33 16 32.40534		LONGITUDE 96 34 07.44374	
GRID FACTOR: 0.99985191					
ELEVATION (FT) 675.875	TIME START 12:35 PM END 3:35 PM		ANTENNA HEIGHT (MEASURED FROM HOOK) FEET 5.220 METERS 1.591		

## STATION DESCRIPTION:

2 inch aluminum disk stamped "R.P.L.S. 5430" "GPS Mon" "BF-1" "M.S.M. Inc." set in concrete at the northeast corner of Berry Rd. and Thornberry Rd. Monument is approx. 21' southwest of a fire hydrant, approx. 52' north of Thornberry Rd., and approx. 19' northeast from a Stop sign.

## REMARKS:

Log file: log1205b.tps

## STATION SKETCH:

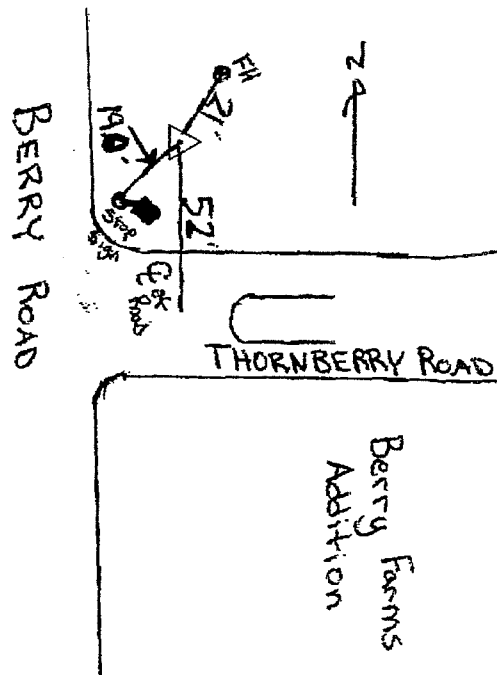
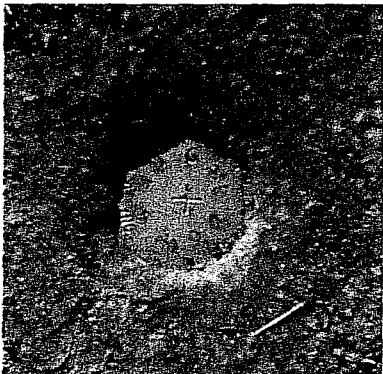
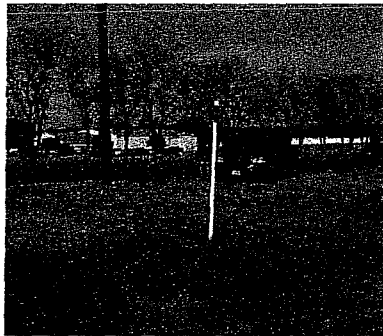

# GPS SURVEY NEW MONUMENT DATA SHEET

CITY OF MELISSA  
901 State Highway 121  
Melissa, TX 75454-9501  
(972) 838-2338



UNIT SERIAL NO.

DC-2

CREW MEMBERS:

BM/JT

STATION NAME (PID):

LAT-1

PROJECT NAME:

MELISSA

DATE:

12/08/08

GRID COORDINATES

NORTH

7164236.169

EAST

2560367.504

DEGREES / MINUTES / SECONDS

LATITUDE

33 18 28.53660

LONGITUDE

96 33 45.04015

GRID FACTOR:

0.99985293

ELEVATION (FT)

703.637

TIME

START

9:19 AM

END

12:19 PM

ANTENNA HEIGHT  
(MEASURED FROM HOOK)

FEET

4.840

METERS

1.475

STATION DESCRIPTION:

2 inch aluminum disk stamped "R.P.L.S. 5430" "GPS Mon" "LAT-1" "M.S.M. Inc." set in concrete at the northeast corner of Highway 5 and a gravel drive. Monument is directly across from Keever's Mobile Home Park located on the west side of Highway 5. Monument is approx. 37.5' east of the centerline of Highway 5, approx. 70' northwest from a Stop sign, and approx. 130' southwest from a power pole.

REMARKS:

Log file: log1208a.tps

STATION SKETCH:

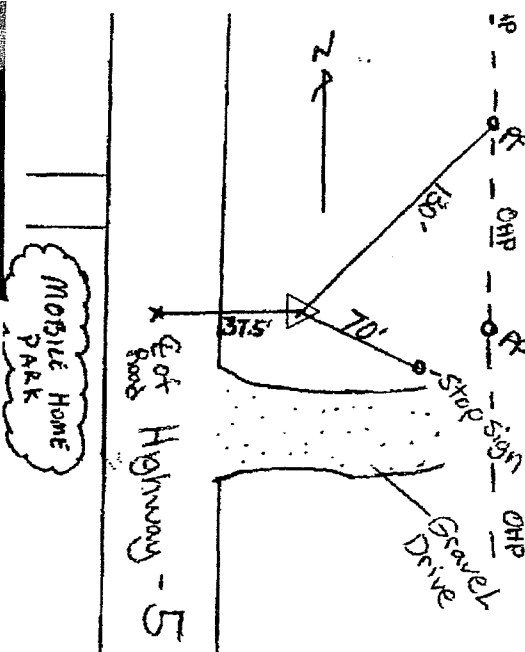

# GPS SURVEY NEW MONUMENT DATA SHEET

CITY OF MELISSA  
901 State Highway 121  
Melissa, TX 75454-9501  
(972) 838-2338



UNIT SERIAL NO.

DC-1

CREW MEMBERS:

DG/BM

STATION NAME (PID):

LIBERTY-1

PROJECT NAME:

MELISSA

DATE:

11/21/08

GRID COORDINATES

NORTH

7156555.348

EAST

2561718.893

DEGREES / MINUTES / SECONDS

LATITUDE

33 17 12.30376

LONGITUDE

96 33 30.79067

GRID FACTOR:

0.99985370

ELEVATION (FT)

654.700

TIME

START

9:05 AM

END

1:25 PM.

ANTENNA HEIGHT  
(MEASURED FROM HOOK)

FEET

5.380

METERS

1.640

STATION DESCRIPTION:

3 inch aluminum disk stamped "Carter-Burgess" "Property Corner" set in concrete at the southwest corner of Independence Drive and Liberty Way. Monument is approx. 27' east from a corner of a brick wall and approx. 60' northwest from the north end of a headwall. Headwall contains 2 - 3X8 box culverts.

REMARKS:

Log file: log1121a.tps

STATION SKETCH:

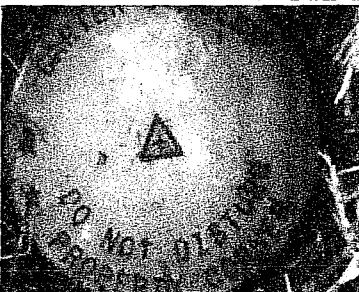
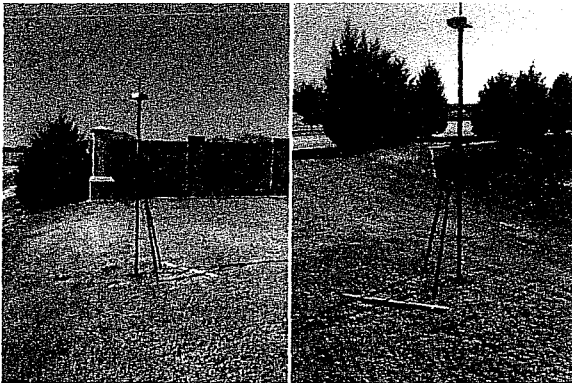

N  
↑

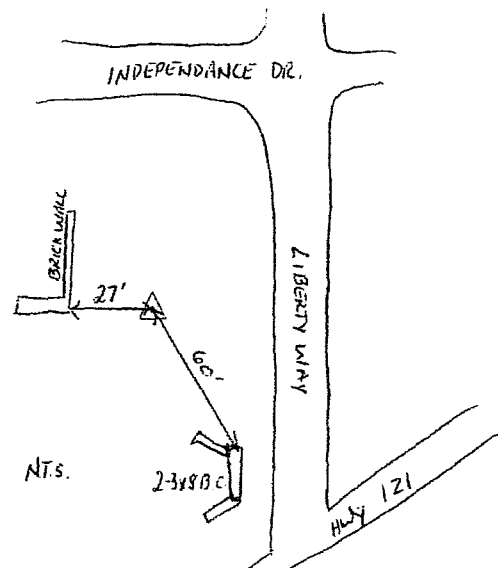

# GPS SURVEY NEW MONUMENT DATA SHEET

CITY OF MELISSA  
901 State Highway 121  
Melissa, TX 75454-9501  
(972) 838-2338

UNIT SERIAL NO.

CREW MEMBERS:

DC-1

DG/BM

STATION NAME (PID):

LIBERTY-2

PROJECT NAME:

MELISSA

DATE:

11/21/08

GRID COORDINATES

NORTH

7159119.756

EAST

2561765.680

DEGREES / MINUTES / SECONDS

LATITUDE

33 17 37.66481

LONGITUDE

96 33 29.68118

GRID FACTOR:

0.99985404

ELEVATION (FT)

658.240

TIME

START

12:35 PM

END

3:55 PM.

ANTENNA HEIGHT  
(MEASURED FROM HOOK)

FEET

6.700

METERS

2.042



STATION DESCRIPTION:

3 inch aluminum disk stamped "Carter-Burgess" "Property Corner" set in concrete slightly north of Revere Court cul-de-sac. Monument is approx. 34' southeast from the south end of a headwall that contains 7-3X8 box culverts, approx. 28.5' westerly from the corner of a wood fence, and 28' northeast from a 12 inch bois-de-arc.

REMARKS:

Log file: log1121b.tps

STATION SKETCH:

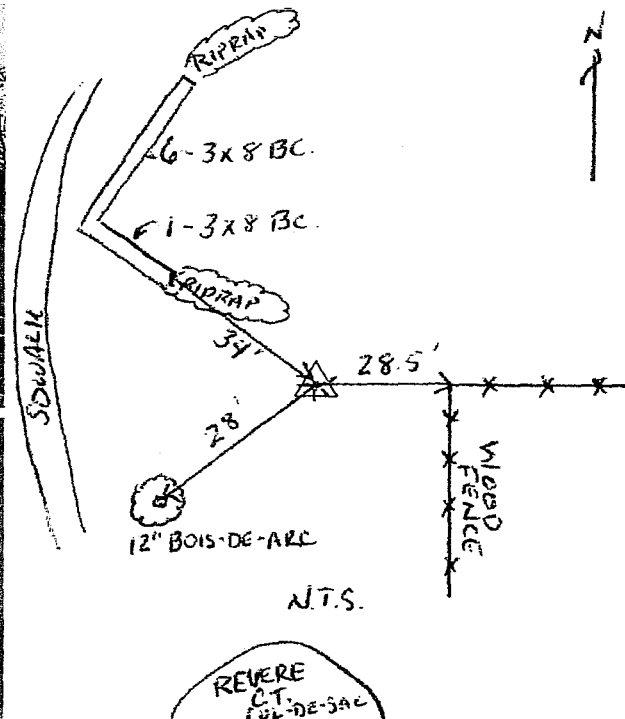
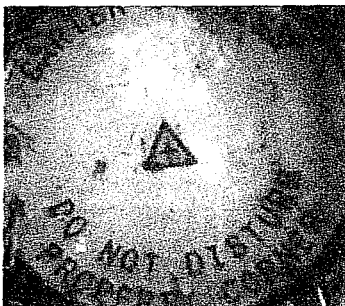
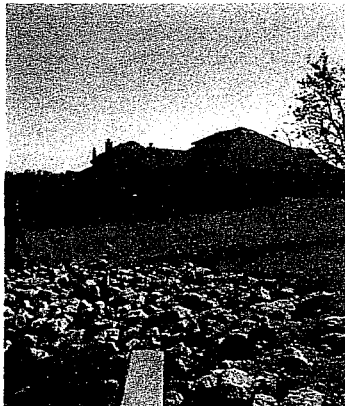



# GPS SURVEY NEW MONUMENT DATA SHEET

CITY OF MELISSA  
901 State Highway 121  
Melissa, TX 75454-9501  
(972) 838-2338



UNIT SERIAL NO. DC-1		CREW MEMBERS: DG/BM		STATION NAME (PID): MR-1		PROJECT NAME: MELISSA		DATE: 11/21/08	
GRID COORDINATES				DEGREES / MINUTES / SECONDS					
NORTH 7155592.164		EAST 2556722.068		LATITUDE 33 17 03.68481		LONGITUDE 96 34 29.85716			
GRID FACTOR: 0.99985371									
ELEVATION (FT) 676.130		TIME START 1:54 PM. END 2:15 PM.		ANTENNA HEIGHT (MEASURED FROM HOOK) FEET 6.700 METERS 2.042					

## STATION DESCRIPTION:

3 inch aluminum disk stamped "City of Melissa" "Survey Marker" "ROW" set in concrete near the northeast corner of the parking lot of St. Paul Baptist Church located at the southwest corner of Melissa Road and Highway 5. Monument is approx. 99' south of the centerline of Melissa Road, approx. 15.2' northwest of the northeast corner of said parking lot, and 34.5' northwest from a power pole.

## REMARKS:

Log file: log1121d.tps

## STATION SKETCH:

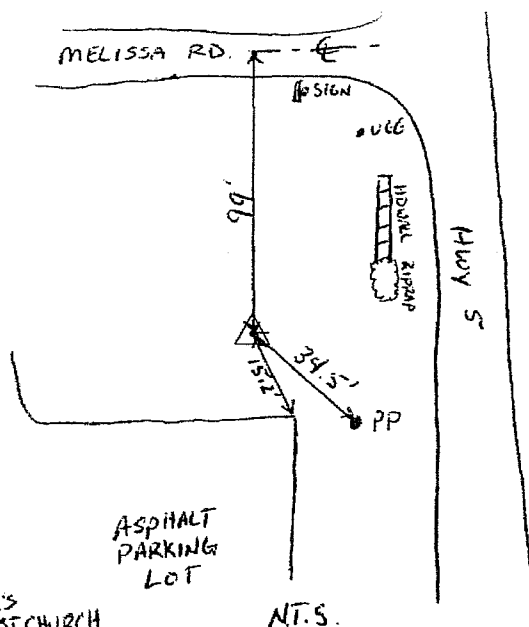
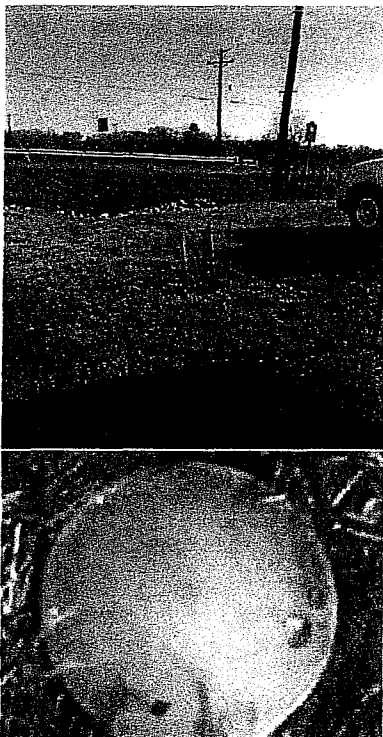

# GPS SURVEY NEW MONUMENT DATA SHEET

CITY OF MELISSA  
901 State Highway 121  
Melissa, TX 75454-9501  
(972) 838-2338

UNIT SERIAL NO.

DC-1

CREW MEMBERS:

BM/JT

STATION NAME (PID):

NC-1

PROJECT NAME:

MELISSA

DATE:

12/05/08

GRID COORDINATES

NORTH

7163241.408

EAST

2566826.713

DEGREES / MINUTES / SECONDS

LATITUDE

33 18 17.51047

LONGITUDE

96 32 29.15659

GRID FACTOR:

0.99985309

ELEVATION (FT)

695.425

TIME

START

9:25 AM

END

12:25 PM

ANTENNA HEIGHT  
(MEASURED FROM HOOK)

FEET

4.840

METERS

1.475



STATION DESCRIPTION:

2 inch aluminum disk stamped "R.P.L.S. 5430" "GPS Mon" "NC-1" "M.S.M. Inc." set in concrete at the northwest corner of Throckmorton Rd and FM 418. Monument is approx. 16' north of the centerline of Throckmorton Rd., approx. 28.5' southeast from the westerly end of the North Creek entrance sign, and approx. 23.6' southwesterly from an "X" found in the centerline of FM 418.

REMARKS:

Log file: log1205a.tps

STATION SKETCH:

